

Equal elbow (body only)  
Winkel-Stutzen  
Union équerre (corps)

Spojka úhlová  
Könyök csatlakozó

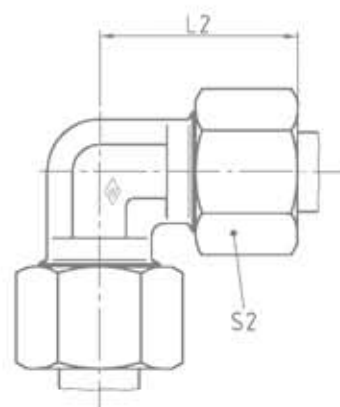

WS .....

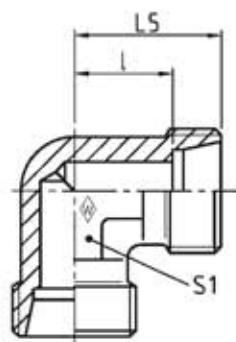

Series	bar	Tube OD	Type	Reference	kg per 100 pcs.					
Reihe	PN	Rohr-AD	Typ	Best.-Nr.	kg per 100 St.					
Série	(psi)	Tube Ø ext.	Désignation	Réf.	kg par 100 p.					
						L <sub>2</sub>	L <sub>5</sub>	l	S <sub>1</sub>	S <sub>2</sub>
LL	100 (1450)	4	<b>WS 4 LL</b>	<b>037863</b>		21	15	11	9	10
		6	<b>WS 6 LL</b>	<b>037865</b>		21	15	9,5	9	12
		8	<b>WS 8 LL</b>	<b>037866</b>		23	17	11,5	12	14
L	500 (7252)	6	<b>WS 6 L</b>	<b>037867</b>		27	19	12	12	14
		8	<b>WS 8 L</b>	<b>037868</b>		29	21	14	12	17
		10	<b>WS 10 L</b>	<b>037869</b>		30	22	15	14	19
	400 (5801)	12	<b>WS 12 L</b>	<b>037870</b>		32	24	17	17	22
		15	<b>WS 15 L</b>	<b>037871</b>	7,5	36	28	21	19	27
		18	<b>WS 18 L</b>	<b>037872</b>	11,2	40	31	23,5	24	32
		22	<b>WS 22 L</b>	<b>037873</b>	14,9	44	35	27,5	27	36
250 (3626)	28	<b>WS 28 L</b>	<b>037874</b>	25,2	47	38	30,5	36	41	
	35	<b>WS 35 L</b>	<b>037875</b>	46,5	56	45	34,5	41	50	
S	800 (11603)	6	<b>WS 6 S</b>	<b>037877</b>		31	23	16	12	17
		8	<b>WS 8 S</b>	<b>037878</b>		32	24	17	14	19
		10	<b>WS 10 S</b>	<b>037879</b>		34	25	17,5	17	22
	630 (9137)	12	<b>WS 12 S</b>	<b>037880</b>		38	29	21,5	17	24
		14	<b>WS 14 S</b>	<b>037881</b>	9,8	40	30	22	19	27
	420 (6091)	16	<b>WS 16 S</b>	<b>037882</b>	14,4	43	33	24,5	24	30
		20	<b>WS 20 S</b>	<b>037883</b>	20,0	48	37	26,5	27	36
		25	<b>WS 25 S</b>	<b>037884</b>	36,5	54	42	30	36	46
		30	<b>WS 30 S</b>	<b>037885</b>	46,5	62	49	35,5	41	50
		38	<b>WS 38 S</b>	<b>037886</b>	66,0	72	57	41	50	60

L<sub>2</sub> = approximate length with nut tightened  
L<sub>2</sub> = Ungefährmaß bei angezogener Überwurfmutter  
L<sub>2</sub> = longueur approximative, l'écrou étant bloqué